



MKP  
MANAGEMENT

## 34df Westminster Road, Selly Oak, Birmingham, B29 7RS

### £96 Per Week

 4  2  1  D

2026/2027 ACADEMIC YEAR Spacious Student Accommodation Suitable for both Students and Professionals

- 15 -20 minutes' walk to South Gate of Campus
- 8-10 minutes' walk to mainline train service run from Selly Oak and Bristol Road
- 4 minutes' to local shops
- 4 Double Bedroom
- Fully Furnished
- Recently redecorated and refurbished.
- Well-equipped Kitchen
- Comfortable Living Space
- Two modern bathroom.
- Gas Central Heating
- Security Alarm
- LOW DEPOSIT: £400/person (based on a group of 4 people)
- Available: Rent with Built-in Unlimited Bills Package for only £128.90 per person per week

Explore this newly refurbished 4 double bedroom student house on Westminster Road, Selly Oak. Situated in a prime location, it's just an 8-10 minute walk to train services, Bristol Road shopping, and various dining options. The property features modern amenities, including a well-equipped kitchen, comfortable living space, and gas central heating, making it a convenient and cozy choice for students.

Don't miss your chance to view this exceptional property. Schedule a viewing by appointment only with MKP Management. Your dream home in Selly Oak awaits!

MKP  
MANAGEMENT

### Viewing

Please contact our MKP MANAGEMENT Office on 0121 472 5897 if you wish to arrange a viewing appointment for this property or require further information.

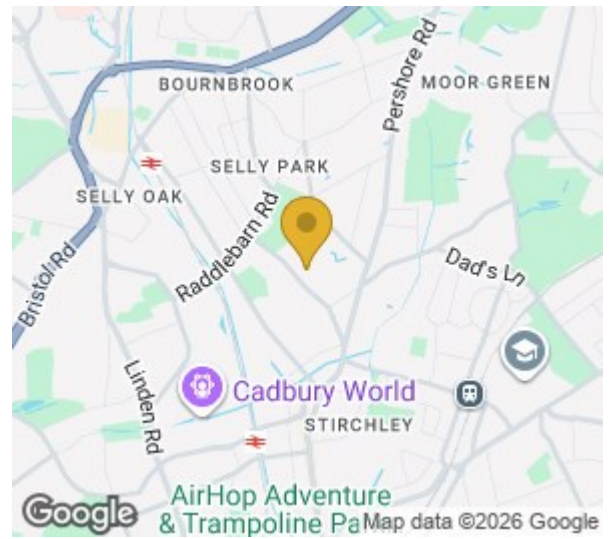
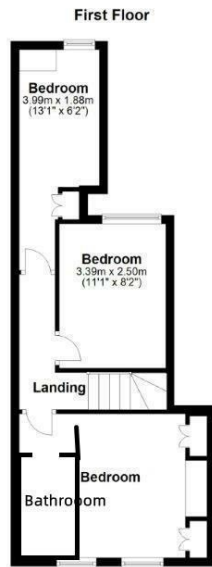

| Energy Efficiency Rating                    |   | Current                 | Potential |
|---|---|-------------------------|-----------|
| Very energy efficient - lower running costs |   |                         |           |
| (92 plus)                                   | A |                         | 79        |
| (81-91)                                     | B |                         |           |
| (69-80)                                     | C |                         |           |
| (55-68)                                     | D | 58                      |           |
| (39-54)                                     | E |                         |           |
| (21-38)                                     | F |                         |           |
| (1-20)                                      | G |                         |           |
| Not energy efficient - higher running costs |   |                         |           |
| England & Wales                             |   | EU Directive 2002/91/EC |           |

| Environmental Impact (CO <sub>2</sub> ) Rating                  |   | Current                 | Potential |
|---|---|-------------------------|-----------|
| Very environmentally friendly - lower CO <sub>2</sub> emissions |   |                         |           |
| (92 plus)   | A |                         | 75        |
| (81-91)   | B |                         |           |
| (69-80)   | C |                         |           |
| (55-68)   | D |                         |           |
| (39-54)   | E | 51                      |           |
| (21-38)   | F |                         |           |
| (1-20)  | G |                         |           |
| Not environmentally friendly - higher CO <sub>2</sub> emissions |   |                         |           |
| England & Wales   |   | EU Directive 2002/91/EC |           |



These particulars, whilst believed to be accurate are set out as a general outline only for guidance and do not constitute any part of an offer or contract. Intending purchasers should not rely on them as statements of representation of fact, but must satisfy themselves by inspection or otherwise as to their accuracy. No person in this firm's employment has the authority to make or give any representation or warranty in respect of the property.